



SOBHA SEAHAVEN

TOWER B

The sea has a  
new address



Take your imagination  
beyond the horizon



Wake up to the sounds of life  
by the water's edge





## A Symphony of Splendor and the Sea

Introducing a new tower at Sobha SeaHaven – where the horizon is as boundless as your dreams.

It's a mesmerizing oasis of luxury living nestled along the pristine Dubai Harbour.



\*For illustrative purposes only

WELCOME TO

  
SOBHA SEAHAVEN  
TOWER B

The kaleidoscope of colors painted over the sky  
raises a toast to live life to the fullest.



A new landmark  
in the seascape

After the stunning success of SeaHaven Tower A, comes a new opportunity at Sobha SeaHaven Tower B.

It's a whole new tower rising from the heart of Dubai Harbor with views of Palm Jumeirah and Ain Dubai.



\*For illustrative purposes only

The stunning backdrops of sea, mesmerising skyline,  
and vibrant city make it a story to be told.

Glancing at the landmarks, Sobha SeaHaven Tower B  
is a waterfront living redefined.



The truth is  
in the details

SeaHaven tower's sail-inspired design against the canvas of the sea and sleek silhouette creates a sense of movement. It takes cues from the elegant superyachts with their fluid lines and clean angles. Capturing the essence of the sea.

To make a statement, the facade blends high-quality materials, rich woods, refined metals, glass, and steel.





\*For illustrative purposes only

From the foyer, enter your exquisitely designed suite. Its open-concept layout and floor-to-ceiling windows mimic the panoramic views from a yacht's deck.

Every element is designed for timeless elegance - sumptuous furnishings, custom millwork, and handcrafted cabinetry makes the difference between ordinary and extraordinary living.

Twice is nice

The Sealaven towers are connected by a stunning sky bridge, giving you twice the experience.



For illustrative purposes only



For illustrative purposes only

Where  
Amenities  
become essentials

At SeaHaven Tower B, your every desire is met with effortless grace.  
Extravagance knows no bounds, and every whim is catered to.

Surrender to blissful rejuvenation. Let your senses be tantalized.  
Here over-the-top indulgences are not luxuries but the essence.

Indoor and Outdoor  
Amenities



SOBHA SEAHAVEN



Health club with Sauna & Steam  
Changing Room

Indoor Cinema



Indoor Game Room  
Serviced Club Lounge



Indoor Gym



Pool Deck



Yoga Zone / Meditation Zone

Infinity edge leisure pool facing harbor  
with kid's pool



Day Bed



Outdoor Gym

Family Zone with Barbeque Area



Outdoor Kids' Play Area



Outdoor Cinema





# Location Map

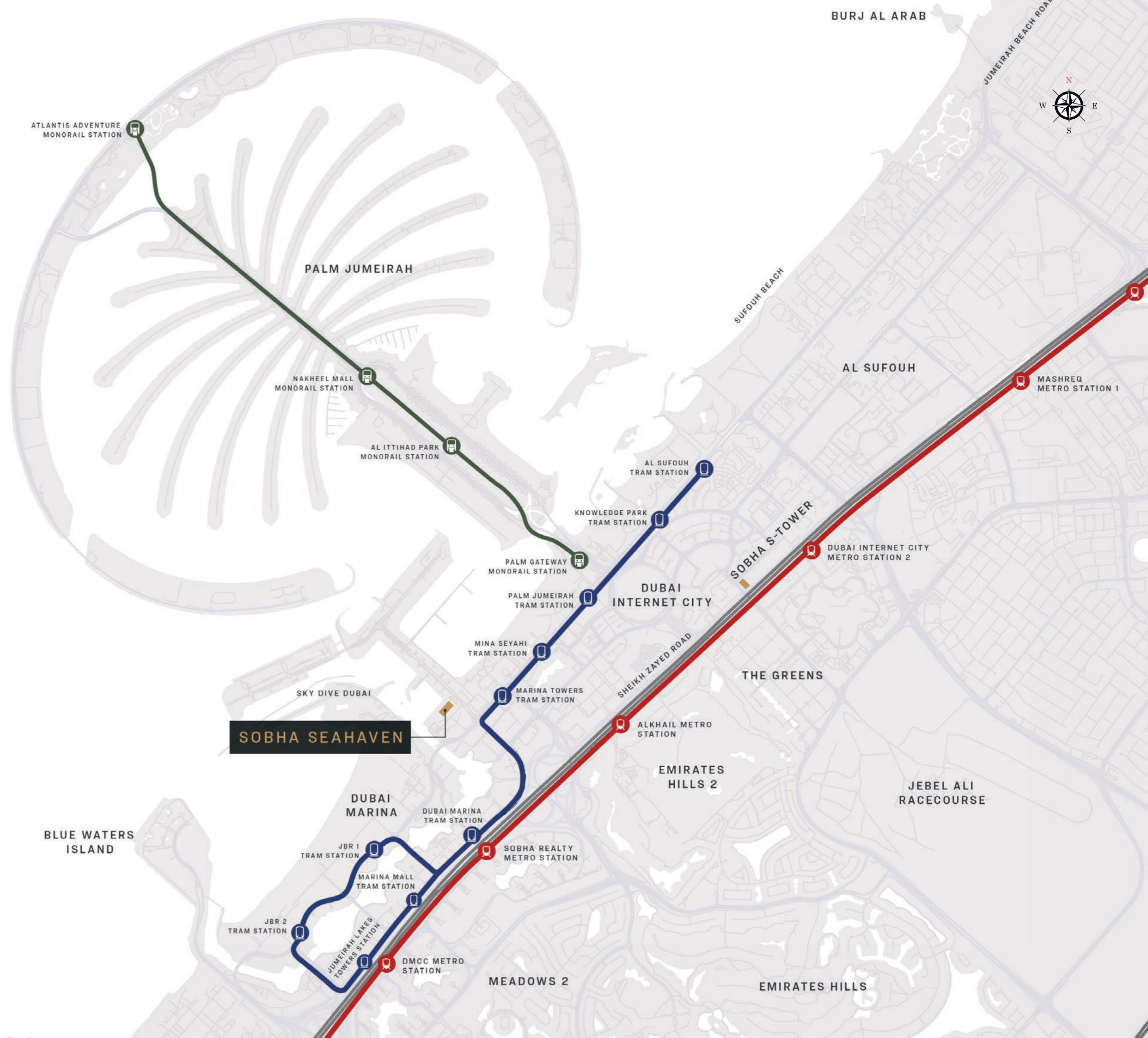

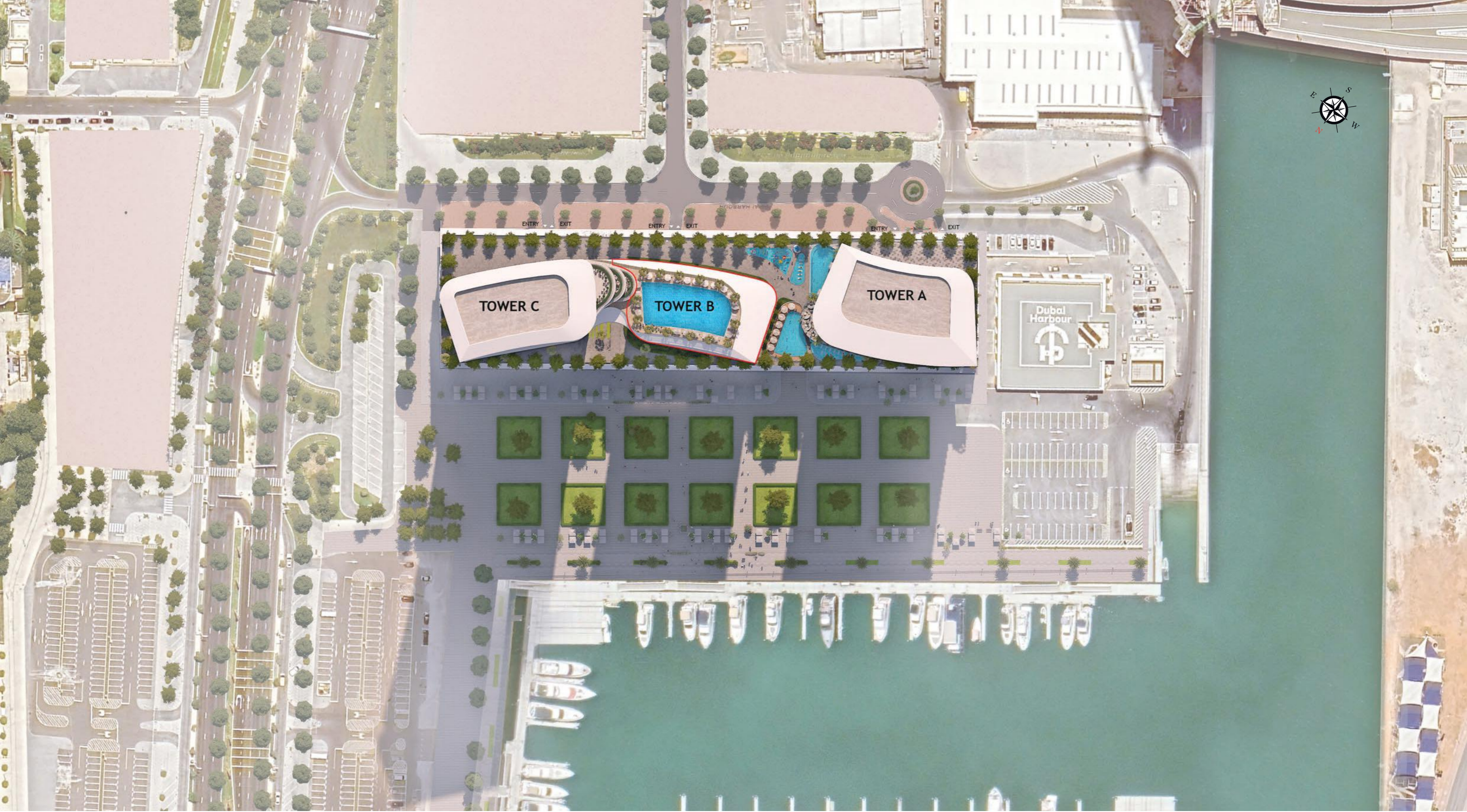

Site Plan

FLOOR AND UNIT PLAN  
LAYOUTS



SOBHA SEAHAVEN

# FLOOR PLAN LAYOUT

## TOWER B

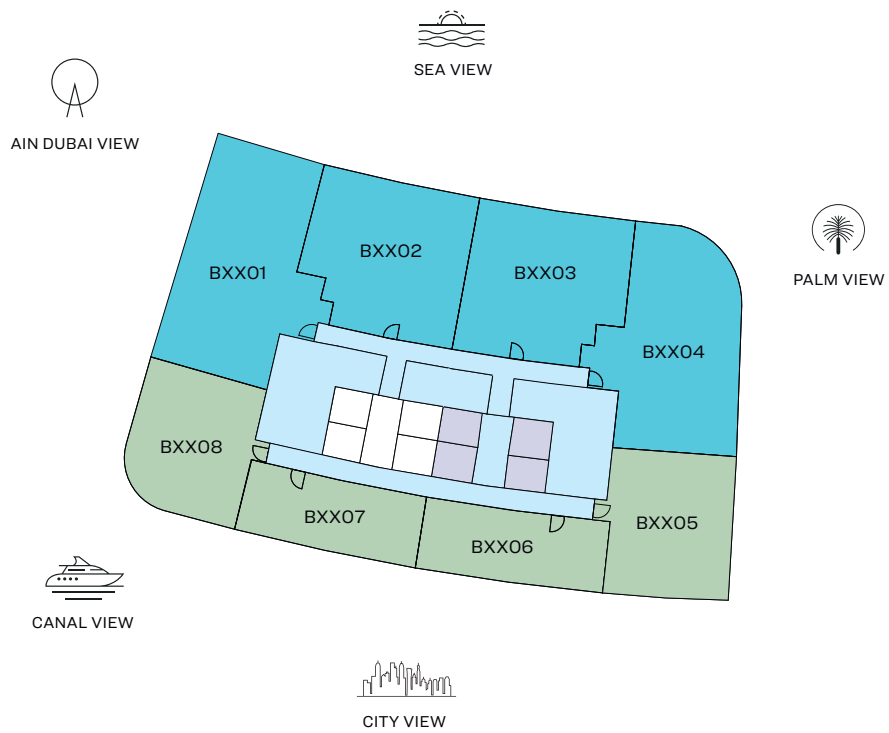

LEVEL 11 - 31

- 1 BED UNIT
- 2 BED UNIT
- LOBBIES, CORRIDORS & STAIRS
- LIFTS

Disclaimer: 1. All dimensions are in metric, measured to wall finishes. 2. All materials, dimensions & drawings are approximate. 3. Information is subject to change without notice, at developer's absolute discretion. 4. Actual area may vary from the stated area. 5. Drawing are not to scale. 6. All images used are for illustrative purpose only and do not represent the actual size, features, specifications, fittings and furnishings. 7. The developer reserves the right to make revisions/ alterations, at its absolute discretion, without any liability whatsoever.

# 2 BEDROOM APARTMENT

## TYPE E (with powder room + balcony)

**TOTAL SALEABLE AREA**

SUITE = 1,749.78 SQ.FT.

BALCONY = 273.30 SQ.FT.

TOTAL = 2,023.08 SQ.FT.



UNIT

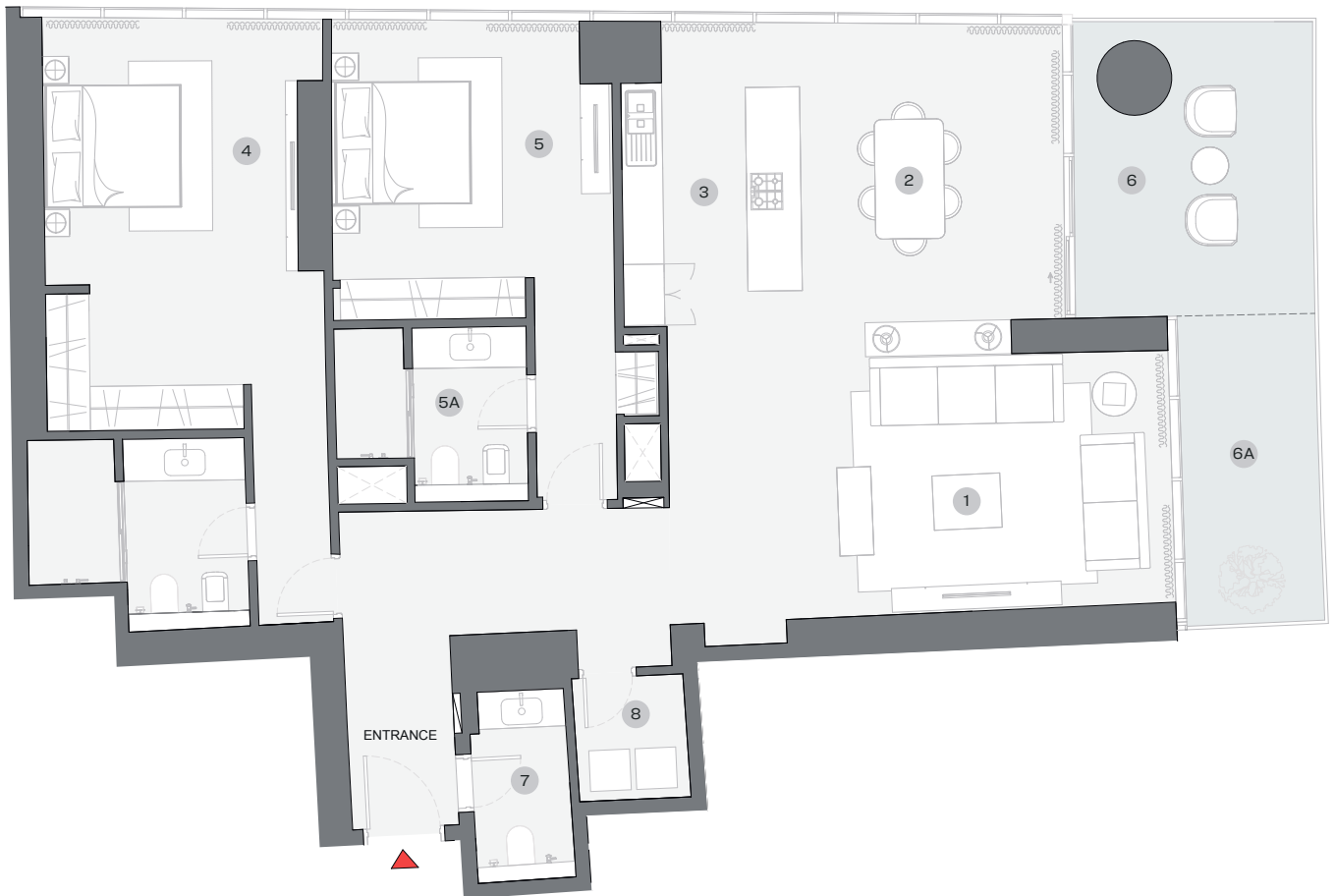

List of unit numbers with this unit plan:

### VIEWS

Blue waters, Ain Dubai, Palm Jumeirah, Harbour, Sea, Skydive  
 B1101, B1201, B1301, B1401, B1501, B1601, B1701, B1801, B1901,  
 B2001, B2101, B2201, B2301, B2401, B2501, B2601, B2701, B2801,  
 B2901, B3001, B3101

### DIMENSIONS (MM)

1 LIVING - 7400 X 3700	4 MASTER BEDROOM - 3700 X 5350	6 BALCONY 1 - 3500 X 4300
2 DINING - 3850 X 4800	4A MASTER BATHROOM - 3200 X 2850	6A BALCONY 2 - 2000 X 4500
3 KITCHEN - 2600 X 4000	5 BEDROOM 2 - 4100 X 4000	7 POWDER - 1450 X 3000
	5A BATHROOM 2 - 2800 X 2550	8 UTILITY - 1650 X 1850

Disclaimer: 1. All dimensions are in metric, measured to wall finishes. 2. All materials, dimensions & drawings are approximate. 3. Information is subject to change without notice, at developer's absolute discretion. 4. Actual area may vary from the stated area. 5. Drawing are not to scale. 6. All images used are for illustrative purpose only and do not represent the actual size, features, specifications, fittings and furnishings. 7. The developer reserves the right to make revisions/ alterations, at its absolute discretion, without any liability whatsoever.

# 2 BEDROOM APARTMENT

## TYPE F (with powder room + balcony)

**TOTAL SALEABLE AREA**

SUITE = 1,273.48 SQ.FT.

BALCONY = 396.76 SQ.FT.

TOTAL = 1,670.24 SQ.FT.



■ UNIT



CITY VIEW  
**LEVEL 11 - 31**



List of unit numbers with this unit plan:

### VIEWS

Palm Jumeirah, Harbour, Sea

B1102, B1202, B1302, B1402, B1502, B1602, B1702, B1802, B1902, B2002, B2102, B2202, B2302, B2402, B2502, B2602, B2702, B2802, B2902, B3002, B3102

### DIMENSIONS (MM)

1 LIVING - 4200 X 4100	4 MASTER BEDROOM - 3900 X 4450	6 BALCONY 1 - 8100 X 3100
2 DINING - 4300 X 2800	4A MASTER BATHROOM - 3000 X 2600	6A BALCONY 2 - 4650 X 2000
3 KITCHEN - 2800 X 2500	5 BEDROOM 2 - 3650 X 3650	7 POWDER - 1800 X 2200
	5A BATHROOM 2 - 2600 X 2600	8 UTILITY - 850 X 1500

Disclaimer: 1. All dimensions are in metric, measured to wall finishes. 2. All materials, dimensions & drawings are approximate. 3. Information is subject to change without notice, at developer's absolute discretion. 4. Actual area may vary from the stated area. 5. Drawing are not to scale. 6. All images used are for illustrative purpose only and do not represent the actual size, features, specifications, fittings and furnishings. 7. The developer reserves the right to make revisions/ alterations, at its absolute discretion, without any liability whatsoever.

# 2 BEDROOM APARTMENT

## TYPE G (with powder room + balcony)

**TOTAL SALEABLE AREA**

SUITE = 1,270.57 SQ.FT.

BALCONY = 394.50 SQ.FT.

TOTAL = 1,665.07 SQ.FT.

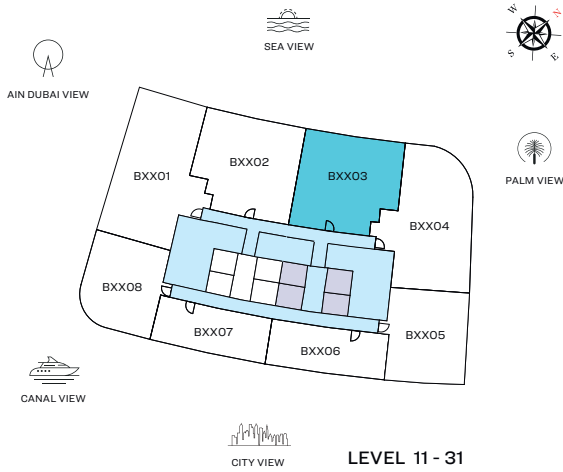

**UNIT**



List of unit numbers with this unit plan:

### VIEWS

Palm Jumeirah, Harbour, Sea

B1103, B1203, B1303, B1403, B1503, B1603, B1703, B1803, B1903, B2003, B2103, B2203, B2303, B2403, B2503, B2603, B2703, B2803, B2903, B3003, B3103

### DIMENSIONS (MM)

1 LIVING - 4150 X 4050	4 MASTER BEDROOM - 3800 X 4450	6 BALCONY 1 - 8000 X 3100
2 DINING - 4300 X 2800	4A MASTER BATHROOM - 3000 X 2600	6A BALCONY 2 - 4600 X 2000
3 KITCHEN - 2850 X 2500	5 BEDROOM 2 - 3800 X 3650	7 POWDER - 1850 X 1950
	5A BATHROOM 2 - 2600 X 2600	8 UTILITY - 850 X 1500

Disclaimer: 1. All dimensions are in metric, measured to wall finishes. 2. All materials, dimensions & drawings are approximate. 3. Information is subject to change without notice, at developer's absolute discretion. 4. Actual area may vary from the stated area. 5. Drawing are not to scale. 6. All images used are for illustrative purpose only and do not represent the actual size, features, specifications, fittings and furnishings. 7. The developer reserves the right to make revisions/ alterations, at its absolute discretion, without any liability whatsoever.

# 2 BEDROOM APARTMENT

TYPE H (with powder room + balcony)

**TOTAL SALEABLE AREA**

SUITE = 1,740.63 SQ.FT.

BALCONY = 189.65 SQ.FT.

TOTAL = 1,930.28 SQ.FT.

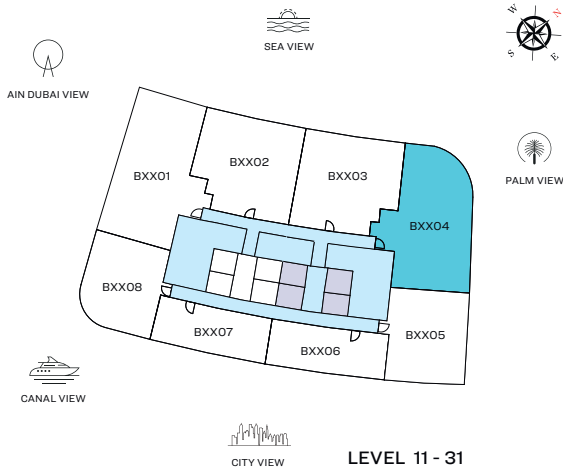

UNIT

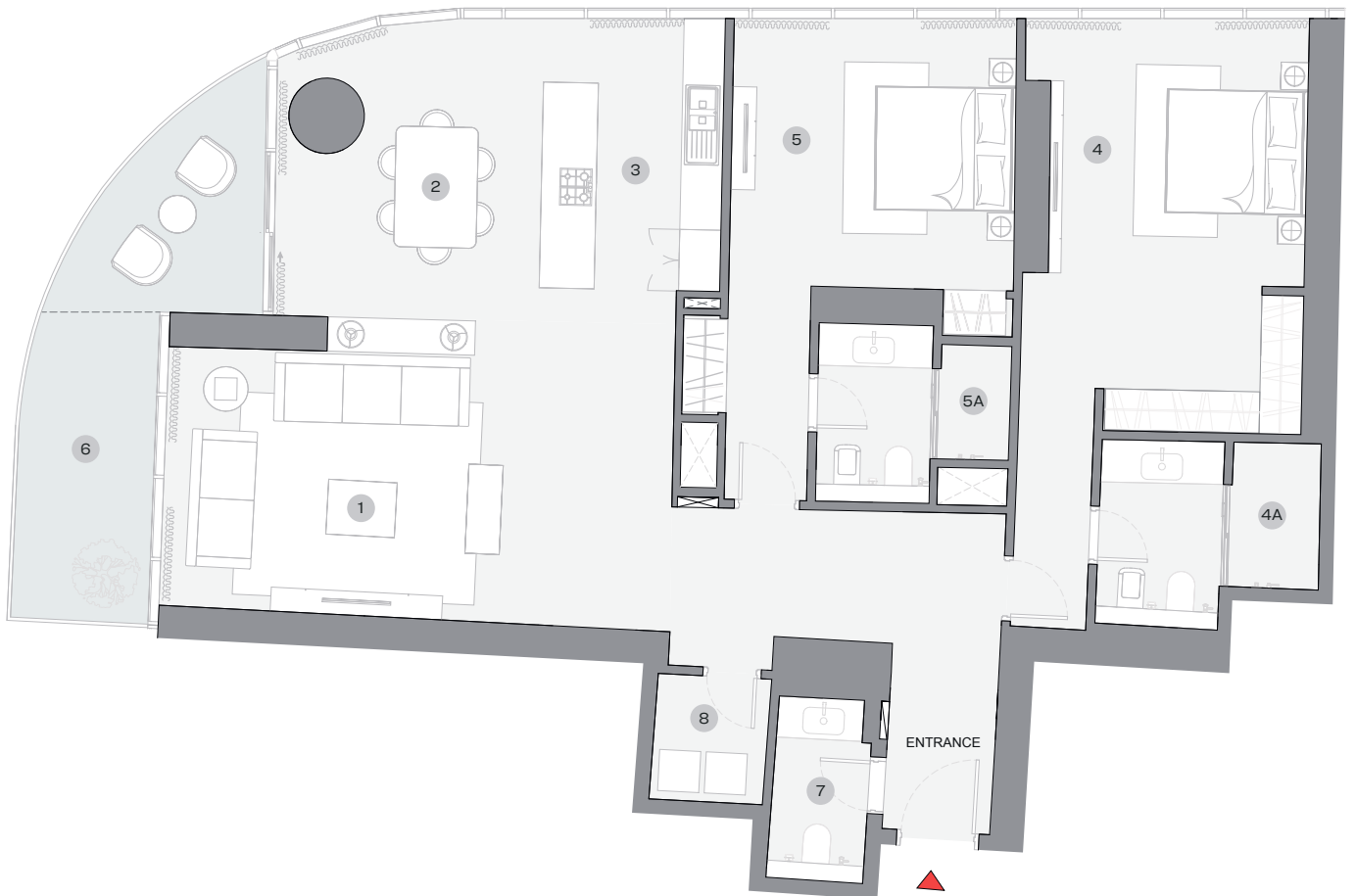
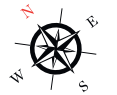

List of unit numbers with this unit plan:

## VIEWS

Palm Jumeirah, Harbour, Sea

B1104, B1204, B1304, B1404, B1504, B1604, B1704, B1804, B1904, B2004, B2104, B2204, B2304, B2404, B2504, B2604, B2704, B2804, B2904, B3004, B3104

## DIMENSIONS (MM)

1 LIVING - 7400 X 3850	4 MASTER BEDROOM - 3700 X 5350	6 BALCONY - 2000 X 4550
2 DINING - 4000 X 4900	4A MASTER BATHROOM - 3200 X 2700	7 POWDER - 1400 X 2850
3 KITCHEN - 2600 X 3950	5 BEDROOM 2 - 4150 X 3850	8 UTILITY - 1650 X 1850
	5A BATHROOM 2 - 2800 X 2550	

Disclaimer: 1. All dimensions are in metric, measured to wall finishes. 2. All materials, dimensions & drawings are approximate. 3. Information is subject to change without notice, at developer's absolute discretion. 4. Actual area may vary from the stated area. 5. Drawing are not to scale. 6. All images used are for illustrative purpose only and do not represent the actual size, features, specifications, fittings and furnishings. 7. The developer reserves the right to make revisions/ alterations, at its absolute discretion, without any liability whatsoever.



# 1 BEDROOM + STUDY APARTMENT

TYPE D (with powder room + balcony)

**TOTAL SALEABLE AREA**

SUITE = 1,102.21 SQ.FT.

BALCONY = 131.43 SQ.FT.

TOTAL = 1,233.64 SQ.FT.



UNIT

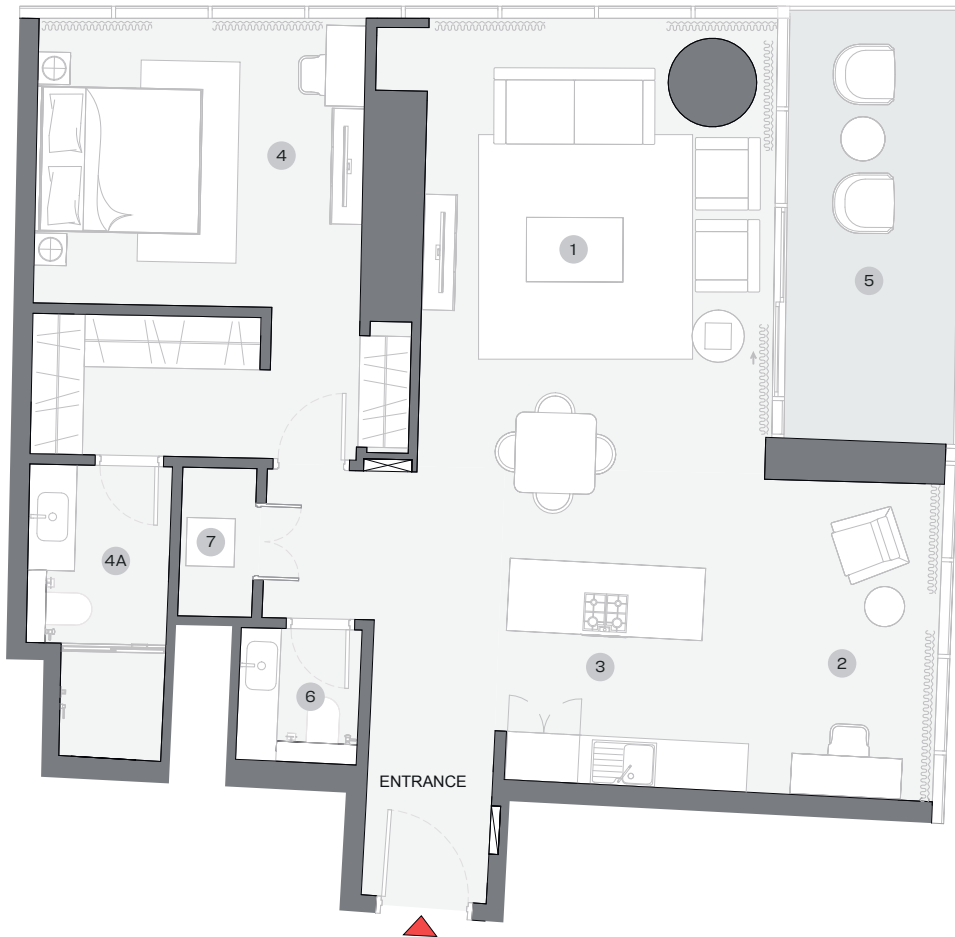

List of unit numbers with this unit plan:

## VIEWS

### Marina Skyline

B1105, B1205, B1305, B1405, B1505, B1605, B1705, B1805, B1905, B2005, B2105, B2205, B2305, B2405, B2505, B2605, B2705, B2805, B2905, B3005, B3105

## DIMENSIONS (MM)

1 LIVING/DINING - 4350 X 6700	4 BEDROOM - 4050 X 3550	5 BALCONY - 2150 X 5250
2 STUDY - 2650 X 3950	4A BATHROOM - 1800 X 3600	6 POWDER - 1500 X 1750
3 KITCHEN - 2650 X 2750		7 UTILITY - 900 X 1850

Disclaimer: 1. All dimensions are in metric, measured to wall finishes. 2. All materials, dimensions & drawings are approximate. 3. Information is subject to change without notice, at developer's absolute discretion. 4. Actual area may vary from the stated area. 5. Drawing are not to scale. 6. All images used are for illustrative purpose only and do not represent the actual size, features, specifications, fittings and furnishings. 7. The developer reserves the right to make revisions/ alterations, at its absolute discretion, without any liability whatsoever.

# 1 BEDROOM APARTMENT

## TYPE E (with powder room + balcony)

**TOTAL SALEABLE AREA**

SUITE = 748.85 SQ.FT.

BALCONY = 92.57 SQ.FT.

TOTAL = 841.41 SQ.FT.



UNIT

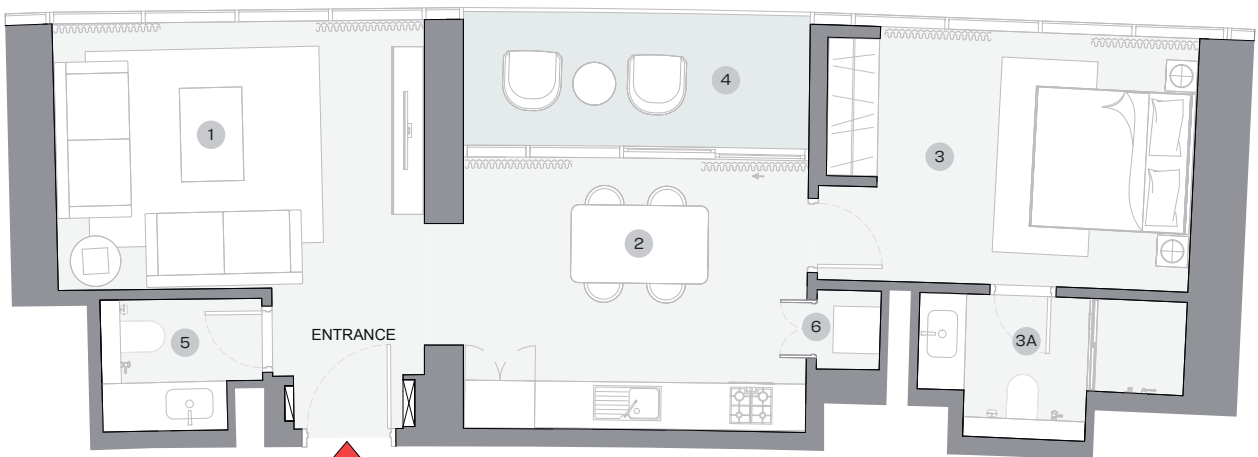

List of unit numbers with this unit plan:

### VIEWS

#### Marina Skyline

B1106, B1206, B1306, B1406, B1506, B1606, B1706, B1806, B1906, B2006, B2106, B2206, B2306, B2406, B2506, B2606, B2706, B2806, B2906, B3006, B3106

### DIMENSIONS (MM)

1 LIVING - 4700 X 3450	3 BEDROOM - 4000 X 3250	4 BALCONY - 4650 X 1700
2 KITCHEN/DINING - 4400 X 3500	3A BATHROOM - 3400 X 1850	5 POWDER - 2050 X 1700
		6 UTILITY - 800 X 1000

Disclaimer: 1. All dimensions are in metric, measured to wall finishes. 2. All materials, dimensions & drawings are approximate. 3. Information is subject to change without notice, at developer's absolute discretion. 4. Actual area may vary from the stated area. 5. Drawing are not to scale. 6. All images used are for illustrative purpose only and do not represent the actual size, features, specifications, fittings and furnishings. 7. The developer reserves the right to make revisions/ alterations, at its absolute discretion, without any liability whatsoever.

# 1 BEDROOM APARTMENT

## TYPE F (with powder room + balcony)

**TOTAL SALEABLE AREA**

SUITE = 754.38 SQ.FT.  
BALCONY = 96.23 SQ.FT.  
TOTAL = 850.61 SQ.FT.



UNIT

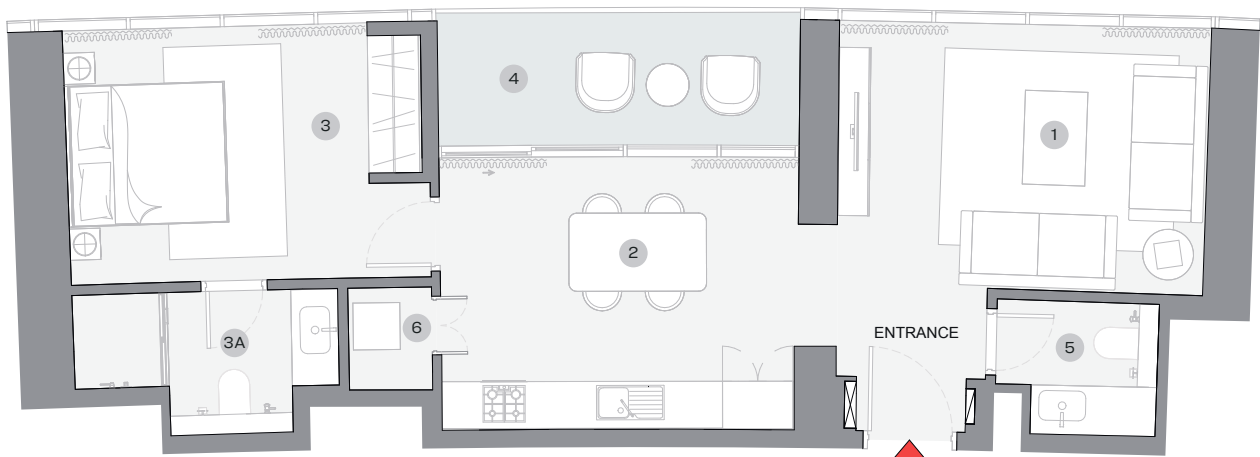

List of unit numbers with this unit plan:

### VIEWS

**Marina Skyline**  
B1107, B1207, B1307, B1407, B1507, B1607, B1707, B1807, B1907,  
B2007, B2107, B2207, B2307, B2407, B2507, B2607, B2707,  
B2807, B2907, B3007, B3107

### DIMENSIONS (MM)

1 LIVING - 4750 X 3400	3 BEDROOM - 3850 X 3250	4 BALCONY - 4650 X 1700
2 KITCHEN/DINING - 4550 X 3500	3A BATHROOM - 3400 X 1850	5 POWDER - 2100 X 1750
		6 UTILITY - 1050 X 1300

Disclaimer: 1. All dimensions are in metric, measured to wall finishes. 2. All materials, dimensions & drawings are approximate. 3. Information is subject to change without notice, at developer's absolute discretion. 4. Actual area may vary from the stated area. 5. Drawing are not to scale. 6. All images used are for illustrative purpose only and do not represent the actual size, features, specifications, fittings and furnishings. 7. The developer reserves the right to make revisions/ alterations, at its absolute discretion, without any liability whatsoever.

# 1 BEDROOM + STUDY APARTMENT

TYPE G (with powder room + balcony)

**TOTAL SALEABLE AREA**

SUITE = 1,086.46 SQ.FT.

BALCONY = 104.15 SQ.FT.

TOTAL = 1,190.62 SQ.FT.

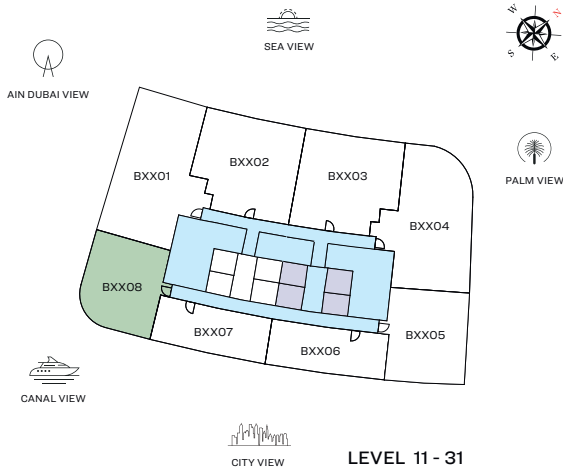

UNIT

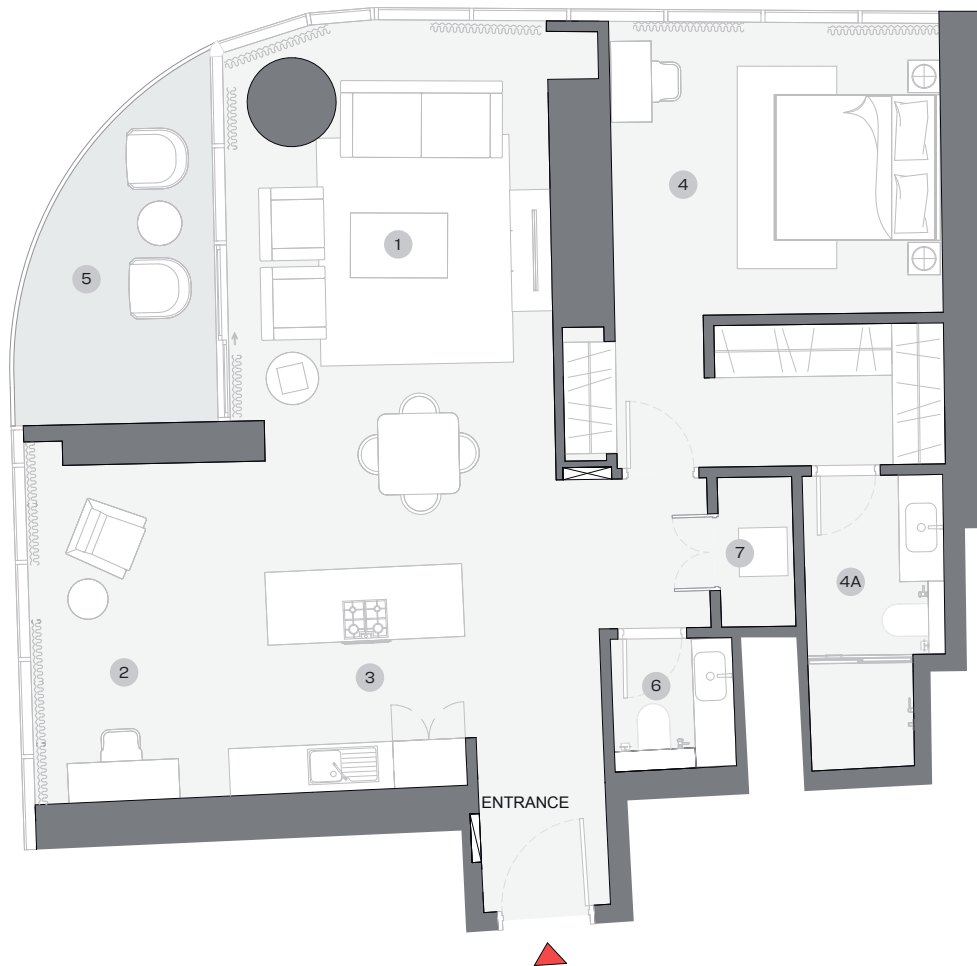

List of unit numbers with this unit plan:

## VIEWS

Marina Skyline, Sea  
B1108

Marina, Marina Skyline, Sea  
B1208, B1308, B1408, B1508, B1608, B1708, B1808, B1908, B2008,  
B2108, B2208, B2308, B2408, B2508, B2608, B2708, B2808,  
B2908, B3008, B3108

## DIMENSIONS (MM)

1 LIVING/DINING - 4000 X 6650	4 BEDROOM - 4100 X 3550	5 BALCONY
2 STUDY - 2650 X 4100	4A BATHROOM - 1750 X 3600	6 POWDER - 1500 X 1600
3 KITCHEN - 2650 X 2700		7 UTILITY - 900 X 1850

Disclaimer: 1. All dimensions are in metric, measured to wall finishes. 2. All materials, dimensions & drawings are approximate. 3. Information is subject to change without notice, at developer's absolute discretion. 4. Actual area may vary from the stated area. 5. Drawing are not to scale. 6. All images used are for illustrative purpose only and do not represent the actual size, features, specifications, fittings and furnishings. 7. The developer reserves the right to make revisions/ alterations, at its absolute discretion, without any liability whatsoever.

SOBHA  
REALTY